

Services and Software

Services and software portfolio for a wide range of requirements

Product Brochure – Issue 04/2019

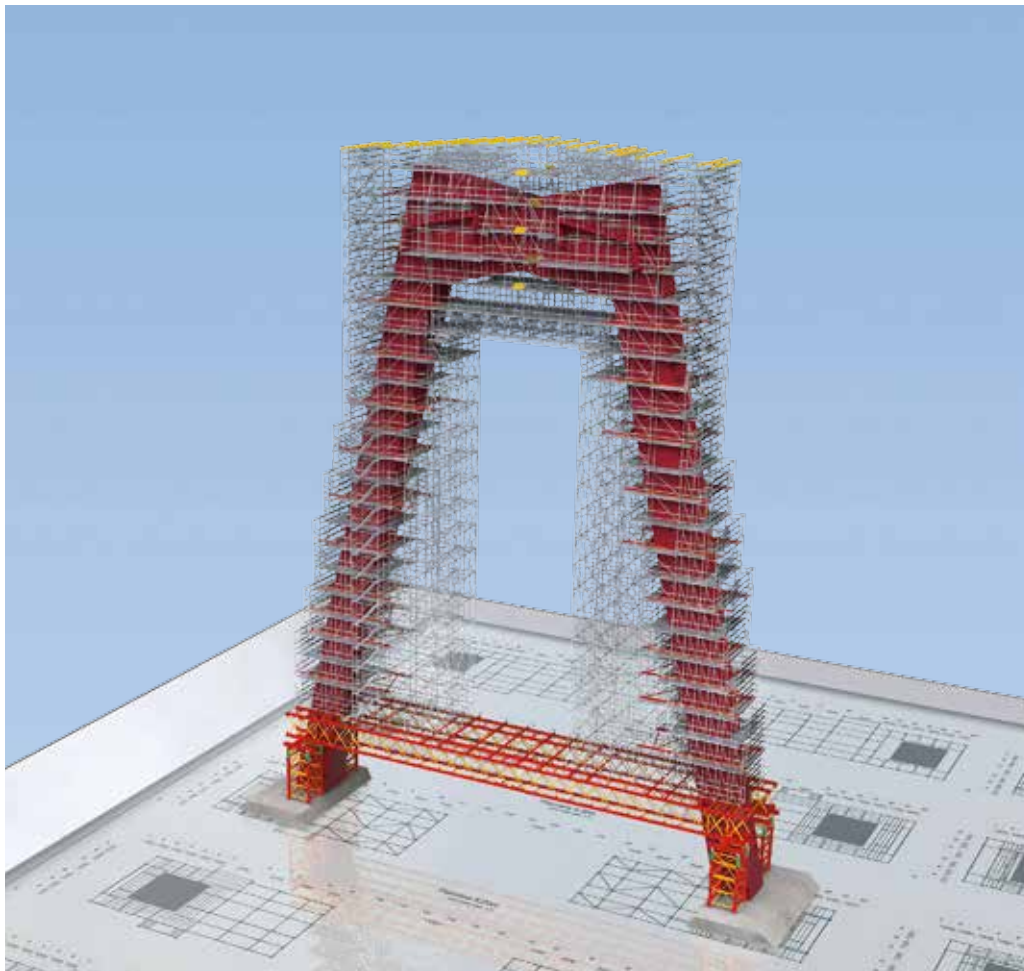



PERI Service and Software Solutions

Individual and digital solutions for the best possible customer success

Extensive services and software options complete PERI's range of formwork and scaffolding and specifically address individual customer requirements. In addition to engineering services, professional project support, equipment services, training, logistics services and BIM-based services, PERI offers numerous apps and software solutions that simplify daily work operations on the construction site.

PERI services and software optimise all processes related to formwork and scaffolding technology and, in so doing, significantly enhance the cost-effectiveness of the project implementation. Thus, the individual planning and advice provided as part of the engineering services contribute to customised formwork and scaffolding solutions. They are aimed at ensuring that PERI formwork and scaffolding systems in construction operations are always used in line with time, cost and quality standards.

If required, PERI also supports customers directly on site, for example, with professional project support. Among other things, a PERI project manager helps to meet budget and schedule requirements.

With the equipment services, PERI also provides professional cleaning and repair of customer materials at numerous locations worldwide. On request, customers benefit from increases in productivity and profitability through the pre-assembly of formwork units.

Practical and theoretical training seminars at PERI exhibition and training centres also contribute to ensuring efficient and resource-optimised work operations and correct product handling.

Thanks to the international PERI rental equipment park network, the high-quality PERI products can also be rented extremely quickly. This is particularly suitable if out-of-the-ordinary applications need to be carried out.

With Building Information Modelling (BIM), PERI also offers a three-dimensional and animated visualisation of the construction processes before the start of the project. This leads to increased cost transparency and efficient execution of the construction work.

Thanks to various apps, important information can also be retrieved on the jobsite within seconds as well as allowing calculations to be made. Software solutions, such as PERI CAD, can reduce costs further and optimise processes even more.

PERI services and software at a glance

- Engineering Services – individual planning for customised solutions
- Project Management – project support and advice
- Equipment Services – professional maintenance operations and assembly
- Courses and Training – for the efficient and safe use of PERI products
- Logistics Services – ideal material quantities at the right time in the right place
- Building Information Modelling (BIM) – for the planning and management of all construction processes
- Software and Apps – digital solutions for planning, preparation and execution

Engineering Services

Individual planning and advice for customised solutions



The engineering services provided by PERI increase planning reliability by means of drawings, parts lists and static calculations.

The aim of the engineering services is to ensure that PERI formwork and scaffolding systems are always used in line with time constraints as well as meeting cost and quality standards. The basis for this is the execution plan records, which are based on 2D-views or

realistically visualised 3D building models. As a result, technical solutions are developed with customers that optimise the use of materials and the construction process itself. Verifiable, static calculations as proof of stability for formwork and scaffolding operations, as well as project-specific installation and assembly plans for the professional assembly of special applications, are also among the range of engineering services. Construction site personnel

can use the plans to assemble the individual PERI components correctly and prepare them for use. PERI also provides an extensive range of customised formwork for the construction of complex, multi-curved reinforced concrete components. To this end, specialists plan and realise accurately designed three-dimensional formwork units based on a 3D building model.



A consistent CAD planning process is realised by bundling the formwork and scaffolding planning.



Implementation plans are coordinated, and it becomes much easier and quicker to organise subsequent plan changes and put them into practice.

Project Management

Professional project support and advice to ensure compliance with budget constraints and scheduling



Through the project management services, PERI provides professional advice and support directly on the construction site – for cost-effective and efficient work processes.

If work procedures in construction site operations are efficient and trouble-free, planning goals can also be achieved. On request, a PERI project manager can support the management and execution of the construction pro-

ject directly on the jobsite. With many years of project experience, they keep a close eye on the entire process chain and can quickly react to deal with site-related changes in the construction process. They also help to find the most economical solution for the project and ensure punctual operational planning of the formwork in line with the construction process. With the support of the online-based myPERI project control tool, project managers

have quick access to all important job-site data. They are the point of contact for all technical, commercial and logistical issues of formwork and scaffolding planning.



Continuous project support provided by a PERI specialist prevents interface losses and ensures efficient work processes.



Advice on safety issues optimises daily work operations on the construction site.



PERI project management also includes the organisation of problem-free return delivery processes.

Equipment Services

Professional maintenance operations and assembly for high material and execution quality



Equipment services from PERI include the cleaning and repair of products, as well as formwork assembly carried out at company's assembly facilities.

Due to the high demands placed on formwork materials, regular maintenance is essential to ensure good execution results. PERI provides professional cleaning and repair of customer materials at many locations worldwide, thus ensuring the quality of the materi-

als held in stock. Pre-assembly of project-specific formwork units can be carried out by PERI assembly specialists at the company's production facility. By relocating assembly operations from the construction site to the factory, the customer can benefit not only from quality advantages but also from increases in productivity and profitability, as well as enhanced cost certainty. As architecture is also becoming increasingly more demanding in both quality and geometry, formwork featur-

ing a wide range of designs is often requested. PERI offers complete solutions from a single source – from simple CNC cut-to-size panels and box outs through to individual special elements, 3D formwork units and platforms. All elements are customised to match all project requirements in the clearly defined quality and suitable for the planned number of uses.



Using state-of-the-art CNC machines, panels are cut ensuring the highest precision and completely in accordance with the specifications of the PERI CAD plan file.



PERI provides customised 3D boxed elements for the construction of complex, multi-curved reinforced concrete components.



Pre-assembly of girder wall formwork, 3D formwork units or heavy-duty shoring structures can also be carried out by PERI.

Courses and Training

Efficient and safe use of PERI products

Practice-relevant further training for different user groups and the professional on-site briefings provided by PERI ensure safe and faster handling and, thus, can reduce the costs.

PERI designs training programmes customised to suit individual needs – tailored to match the formwork and scaffolding systems used by a customer, their special tasks, and general planning and execution of site activities. This allows contractors to realise efficient and resource-optimised work operations during implementation of the project right from the very beginning. In addition to practical training on the systems in the PERI exhibition and training centres worldwide, there are also theoretical training courses and software training. If required, PERI supervisors will provide the construction team with comprehensive on-site support in order to ensure efficient use of PERI system equipment from the start. PERI supervisors also explain plans and parts lists and provide information on the maintenance, cleaning and storage of PERI materials.



Practical sessions provide the ideal opportunity to become familiar with the assembly process.



Training and courses are tailored to meet individual requirements and are offered worldwide.

Logistics Services

The best material in the right quantity, at the right time, in the right place



With well over 140 logistics locations worldwide, PERI provides its customers with innovative system equipment. Very large quantities of high quality materials can also be made available for exceptional orders thanks to the organised exchange of materials between the PERI rental parks.

Freight management at PERI is geared to meeting the special requirements of construction site logistics. If required, PERI will define the project-specific boundary conditions with customers during the planning phase. Thanks to coordinated freight management operations and targeted coordination of the transport and construction site logistics for formwork and scaffolding materials, construction site processes can be optimised and costs reduced. The use of specialised forwarding agencies and close cooperation over deliveries and collections are key elements here.



Peak requirements can be covered cost-effectively by renting materials. In addition, renting the appropriate system equipment is the most suitable option for out-of-the-ordinary applications.

Building Information Modelling (BIM)

Planning and management of all construction processes – from the first idea through to building operation



When it comes to BIM, PERI has been one of the leading companies in the industry for many years now. With software support, the method optimises the planning and execution of structures.

The most important advantage of BIM lies in the fact that planning and design variants of the 3D building model can be simulated at a very early stage of the project. In this way, it will be visible to all parties involved where, when,

why and at what cost can interface problems arise - in the planning of the building and in the subsequent construction work. This future-oriented optimisation of the construction process provides transparent project management and a high level of planning reliability. Through the additional integration of the time and cost factors, the 3-dimensional visualisation of the planning gradually turns into a 4D or 5D model. Additional process data relating to formwork and scaffolding technology,

such as required plan changes, automated collision checks, safety checklists and QR codes for object navigation, are documented in a mobile building information management system. All relevant data is available on the construction site via tablet solutions for day-to-day operations.



The plug-in Library+ for REVIT connects the PERI component catalogues of the MAXIMO and SKYDECK formwork systems in the Autodesk® Revit® software for BIM.



The components of many PERI formwork systems are available in the Tekla Warehouse from Trimble for BIM-related reuse.

Software and Apps

Versatile solutions – from useful tools through to an extensive range of software

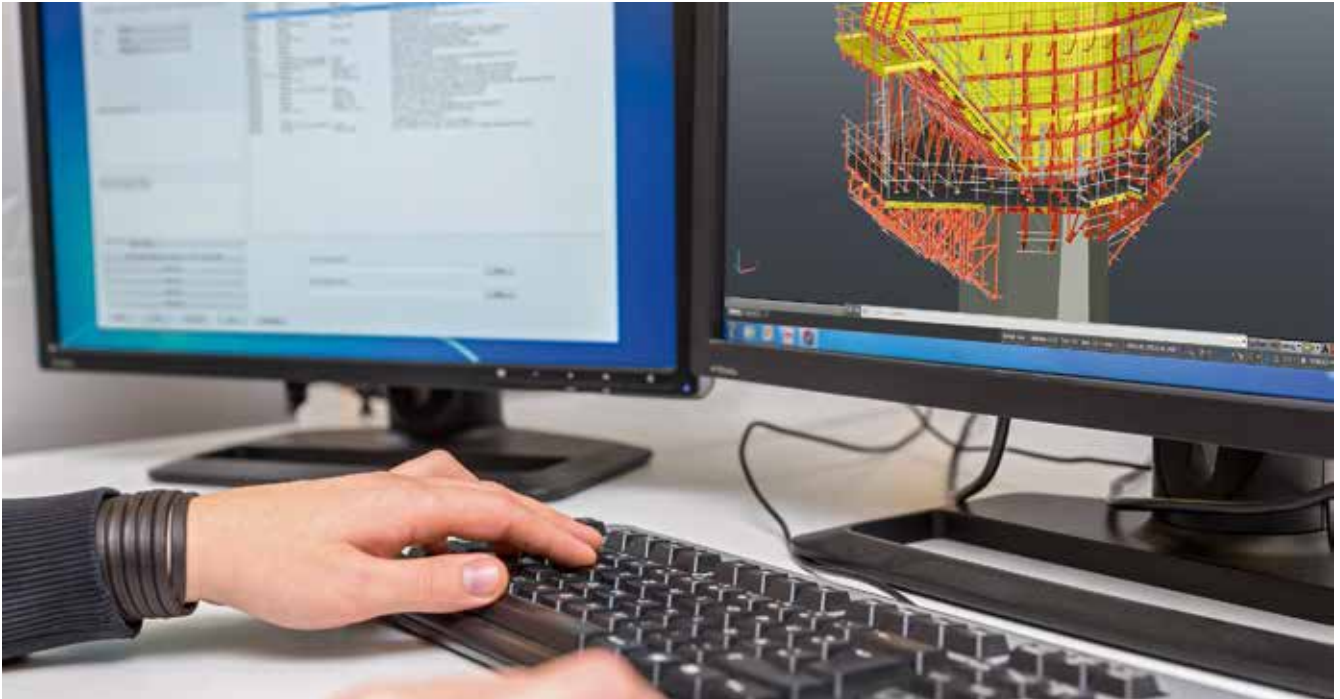

Whether in the office or on the job-site: digital helpers from PERI are valuable tools in the planning, work preparation and execution of formwork and scaffolding projects.

The range of digital applications available today extends from product-related apps for simple calculations for form-

work and scaffolding systems through to the online myPERI customer portal which, as a comprehensive information platform, supports the complete execution time of a project. Clear and simple operability is of paramount importance for all PERI software programs and web tools – while simultaneously ensuring high user benefits.

With PERI CAD software, structures can be planned and then graphically visualised thanks to a 3D design.



With the DUO Planner, formwork solutions can be quickly planned and without any complex software.



The myPERI online customer portal provides clearly presented reports and makes work processes much easier in many respects.

PERI CAD

PERI CAD software is the ideal tool for experienced CAD users and is used for a wide range of tasks – from planning simple ground plans with standard systems through to developing solutions for the most complicated engineering works.



PERI Apps

Intuitively operated apps save time and money in everyday construction activities and make a valuable contribution to on-site safety. The web-based configurators can be used to determine important characteristic values and performance data, as well as the easy planning of specific structures.



myPERI

With the online myPERI customer portal, PERI customers can access all important project data of their respective PERI jobsite. In addition, they can quickly and easily access a comprehensive range of product and component information. Anytime, anywhere.

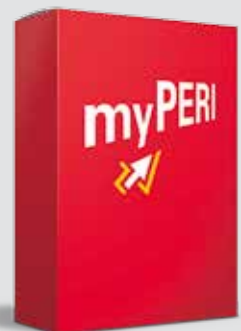

**The optimal System
for every Project and
every Requirement**



Wall Formwork



Column Formwork



Slab Formwork



Climbing Systems



Bridge Formwork



Tunnel Formwork



Shoring Systems



Construction Scaffold



Facade Scaffold



Industrial Scaffold



Access



Protection Scaffold



Safety Systems



**System-Independent
Accessories**



Services



PERI GmbH
Formwork Scaffolding Engineering
 Rudolf-Diesel-Strasse 19
 89264 Weissenhorn
 Germany
 Tel. +49 (0)7309.950-0
 Fax +49 (0)7309.951-0
 info@peri.com
 www.peri.com

